

Safety and environment for external collaborators

vigier ciment
SOLUTIONS PAR PASSION



Safety and environment for external collaborators



Safety and environment

- ✓ In this presentation you will learn the following:
 - ✓ Traffic plan information, risks,
 - ✓ What to do in case of an accident or a fire,
 - ✓ The location of emergency points,
 - ✓ And the main safety regulations applicable on the site

- ✓ Every employee is responsible for his own health and safety, as well as the health and safety of others.

**“Setting a good example is not a way of exerting influence.
It is the only one.” - Albert Schweitzer**

Safety and environment

SAFETY IN THE WORKPLACE 5 BASIC RULES



1

PRIORITIZE

I make safety at work a priority in all my activities. That's why I tell my superiors about any tasks that cannot be carried out safely. And I have the right to refuse work that cannot be done without compromising safety.

2

PLAN

I carry out my work in such a way as not to endanger either myself or my colleagues. That's why, before taking any action, I think about the dangers involved. When I take on new tasks, I make sure beforehand that I have the necessary knowledge to carry them out.

3

PROTECT

I always wear the prescribed personal safety equipment and observe the company's safety instructions.

4

ACT

I don't look away when my colleague is in danger. I point it out and help them to do their job safely.

5

REPORT

I report any dangerous situation or accident in the workplace to my superior without delay. I eliminate any risk immediately or make proposals for improvement.

The health and safety of employees is an absolute priority for Vigier: You must return home as healthy as you came to work.

Extract from Vigier's commitment to safety and health



Traffic plan of the site

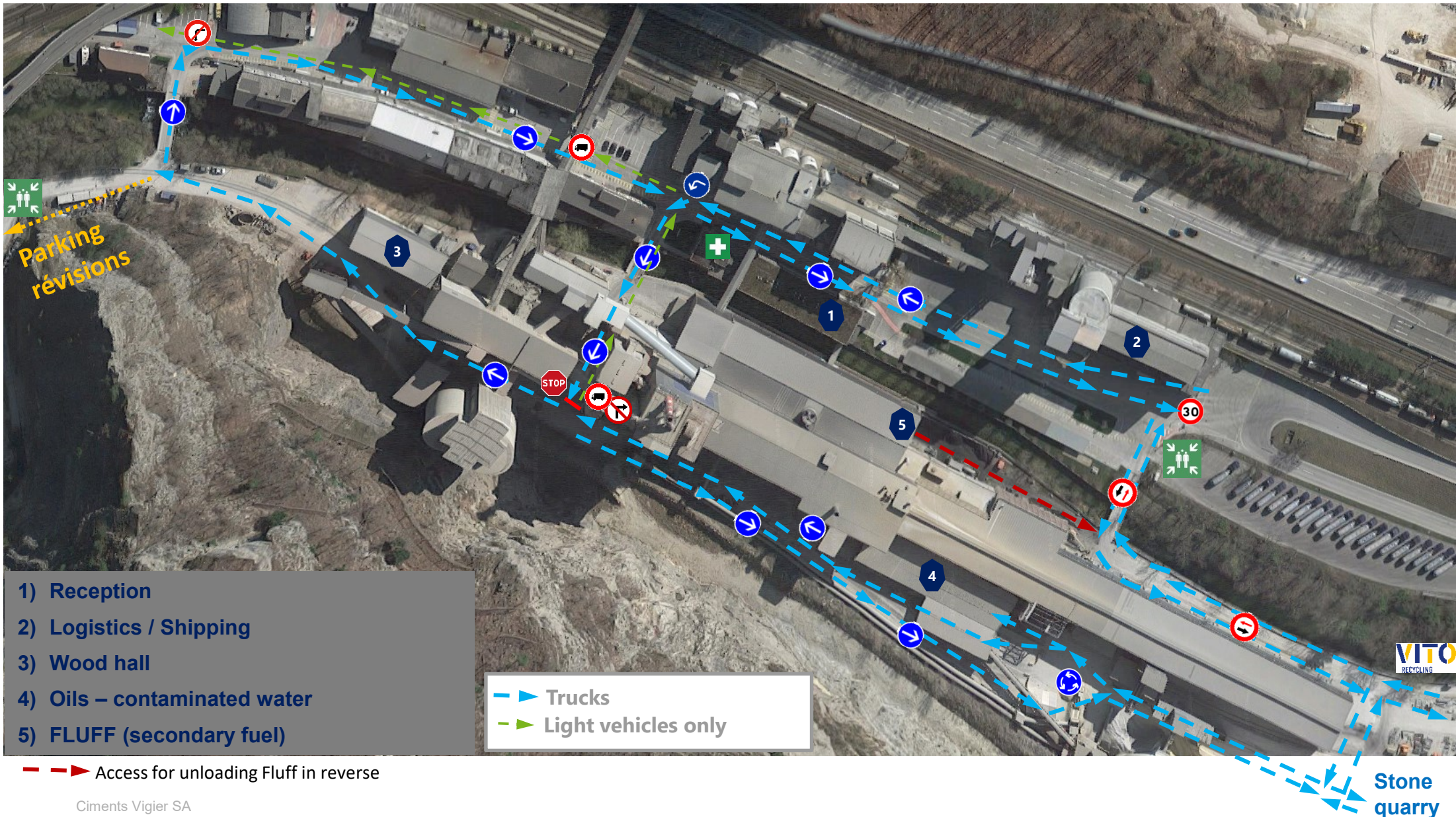

Traffic and Parking



Follow the traffic plan and the signs.

Always maintain visual contact with drivers of construction machinery and trains.

- * P 1A : 31 places
- P 1B : 12 places
- P 2A : 7 places
- P 2B : 19 places including 6 electric places 
- P 3 : 21 places
- P 4 : 30 places
- P 5 : 100 places used by external collaborators during revisions periods



Pedestrian traffic

- ▼ No parking in front of building entrances, fire hydrants and electrical rooms.
↳ During revisions, external companies must park in the car park **P5**

- ▼ No vehicles may be parked outside the car parks.
Except with a permit:



- ▼ Be careful when walking:



- ▼ Caution with vehicles, machines and trains:

- ▼ Watch out for moving vehicles. You have **no right of way** with trains and construction machinery, so make yourself noticed by those in motion and wait for their permission before passing.
- ▼ Make yourself known to the drivers and wait for their approval before passing through.

Warning signals



**Danger: Injection of azote,
risk of asphyxiation**



**Danger: Moving
train**



**Calls to landlines in noisy
areas (heat exchanger/oven
and mills)**



Warning signals



Danger: Air cannons in action



Danger: Cyclone clogging

Halle RO2

Filtre F

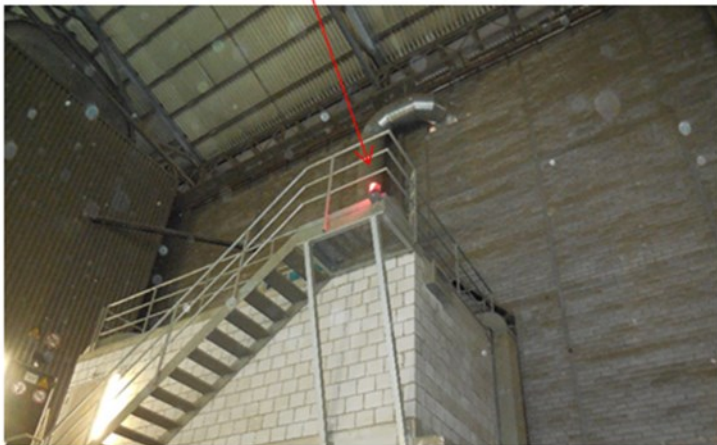

The wearing of PPE on site

— Traffic lanes in the free zone



Personal protective equipment (PPE)

▼ PPE is mandatory on the entire site under all circumstances (exception in emergency points and in the office)

- ▼ Helmet
- ▼ Safety goggles
- ▼ Safety shoes
- ▼ Highly visible / reflective work clothing
- ▼ The wearing of shorts is prohibited



▼ Other PPE may be compulsory depending on the risks involved:



▼ For other premises, follow the obligation signs posted at the entrance to the premises



PPE – Access to the heat exchanger

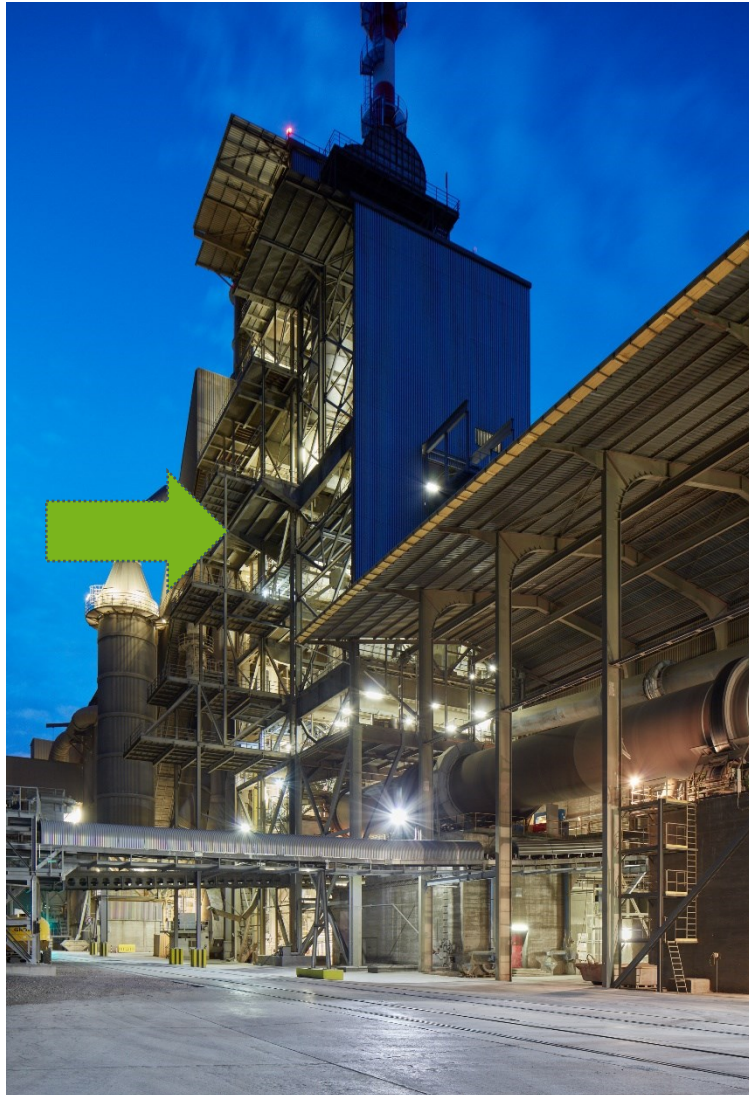

Waterproof or semi-waterproof goggles must be worn



Before starting your work

- ▼ All work must be the subject of a work order. This will be issued by your case manager.

- ▼ A work permit will be issued in case of special risks:
 - ▼ Welding, cutting, grinding work → **Fire permit**
 - ▼ Working in an ATEX zone → **ATEX permit**
 - ▼ Working in restricted zones → **Permit for restricted zones**
 - ▼ Working at heights (outside gondolas and scaffolding) and unsecured roof access → **Heights permit**
 - ▼ Excavation work → **excavation work permit**

- ▼ When maintenance work is to be done with energy:
Each participant must attach his/her padlock to the main switch or the lockbox.



Marking



- ▼ **Secure your work area for yourself and others.**
Lifting work, falling objects, falling from a height, ...
- ▼ **Never cross barriers without being authorized to do so.**
- ▼ **ensure that marking is respected**
- ▼ **At the end of the work, when all the collective protection has been put back in place and/or the risk has disappeared, the site manager must remove the temporary signs she/he had put in place.**

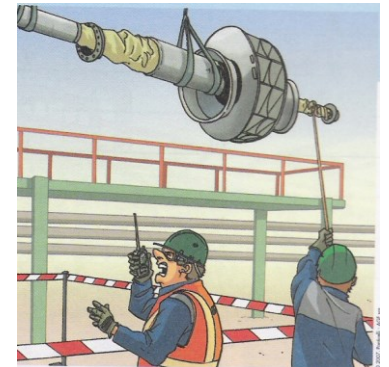

Consignment



▼ All maintenance work should be directed to the Vigier contact.

▼ Types of consignment:

- ▼ Electrical
- ▼ Mechanical
- ▼ Pneumatic
- ▼ Thermal
- ▼ Hydraulic
- ▼ Others

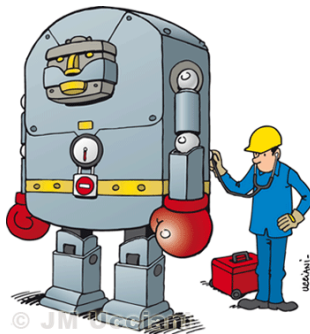

▼ Check with the Vigier contact that the equipment on which you are working is consigned.

▼ No work may begin before the approval of the Vigier contact.



- Please note that a stationary installation does not mean that it has been shut down, let alone locked down.
- Each worker must place his padlock on the main switch or in the hole box.

Use of cranes / crane bridges

▼ How to use a crane bridge or crane on the Ciments Vigier construction site:

- ▼ You must have the necessary training (mandatory Swiss forklift truck examination)
- ▼ You must be in possession of a driving licence:
 - ▼ From your employer
 - ▼ From Vigier Ciments
- ▼ You need to be medically fit.

▼ The machinery of the external companies must be:

- ▼ In good operating condition (check before use)
- ▼ Periodically checked.

▼ List of the devices concerned:

- ▼ Construction machinery
- ▼ Forklift
- ▼ Overhead crane
- ▼ Crane (mobile and tower)
- ▼ Auxiliary loading crane
- ▼ Gondola (Wearing a safety harness is mandatory for some gondolas)



Electrical risk



- ▼ It is forbidden to enter rooms with electricity or to work in an electrical box without the authorization and electronics permission (from the employer and Vigier Ciment).
- ▼ Portable tools/equipment must be in good condition.
- ▼ Small conductive enclosures (closed room with conductive walls):
 - ▼ Examples: Crusher, hopper, cyclone, cooler, furnace, ...
 - ▼ The voltage used must be 24V or an isolation transformer must be used.
- ▼ Contact the Vigier Case Manager via your Site Manager to resolve any electrical problems.
- ▼ Be careful when working near ground and overhead power lines.

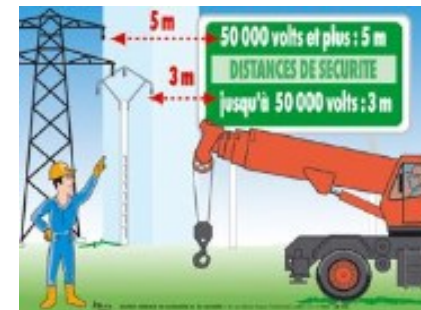

Risk of falling from a height



▼ Ladder: **The ladder is an aid, not a working platform.**

▼ PPE (safety harness, rope, ...)

- ▼ The employee must be trained.
- ▼ The equipment must be in good condition (check before and after use).

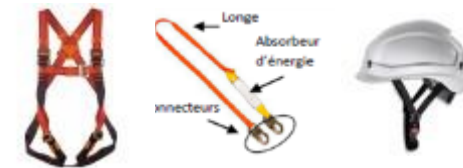

▼ Scaffolding:

- ▼ Are assembled by trained personnel.
- ▼ Must be accepted by a trained person (applicant).
- ▼ Each company ensures that the scaffolding meets its needs.
- ▼ **Each company** ensures that the receipt is available and carries out a **daily check**.
- ▼ **No access until the scaffolding is received!**

Libération		883
Société construction échafaudage: Roth		
Personne de contact :		
N° téléphone :		
Lieu : Tête de four Centre de frais... 80190		
Charge utile	200 kg / m ²	
Cet échafaudage est sûr et l'accès à celui-ci est autorisé 		
Contrôlé: .. 05/06/2020 .. Roth ..		
Libération : après la construction ou la modification uniquement par le responsable de construction de l'échafaudage.		
Date :	Signature :	
Date :	Signature :	
Date :	Signature :	
Toute modification de l'échafaudage est interdite. Seul le constructeur est habilité à effectuer des modifications, le montage ou le démontage.		
En cas de défaut(s) constaté(s) : évacuer l'échafaudage, sécuriser la zone dangereuse et bloquer tous les accès par le panneau [ACCES INTERDIT]. La libération sera faite que par le constructeur une fois l'échafaudage à nouveau sûr.		
Contrôles effectués par le personnel Vigier formé.		
Un contrôle selon les prescriptions de la Suva sera effectué une fois par semaine		
Responsable :Fütterer B.		
Date : 05.06.2020	Signature :	Etat conforme : <input checked="" type="checkbox"/> / non
Date :	Signature :	Etat conforme : oui / non

Unfinished scaffolding



Entry prohibited

Daily scaffold condition check

Since it was delivered, the scaffolding may have suffered some damage linked to:

- Wind
- Temperature variations
- Dismantling of a component by another company (e.G. Dismantling of an engine)
- Impact with machinery
- Deterioration of ground support (rain, etc.)
- Overloading of the boards with equipment
- ...

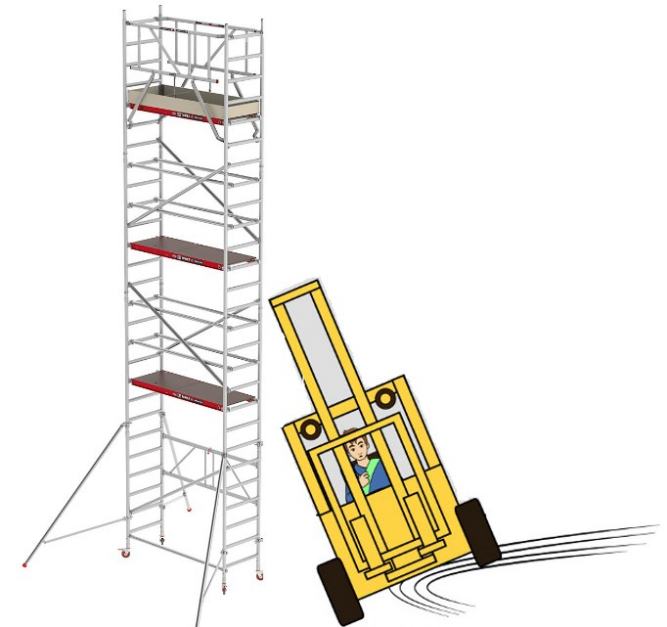

Every day, the team leader of each company using the scaffolding must carry out the daily check. He will certify this check by writing the date, his name, the name of his company and his signature on the back of the release sheet.

Lifting operations



- ▼ Be vigilant.
- ▼ Mark the lifting area.
- ▼ Make sure that your lifting zone is respected.
- ▼ A single, identifiable person is responsible for lifting.
- ▼ Never walk under the load

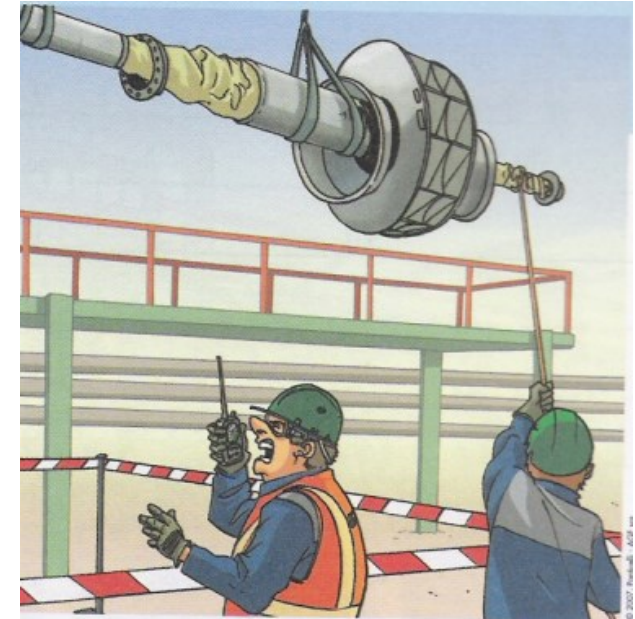

Depending on the type of lifting work, the preparation of a protocol or a permit is mandatory. This is made with Vigier Ciment, the external company and the lifter before the work begins.

Confined spaces

- ▼ Permit to enter issued by Vigier Ciment
- ▼ During work you must:

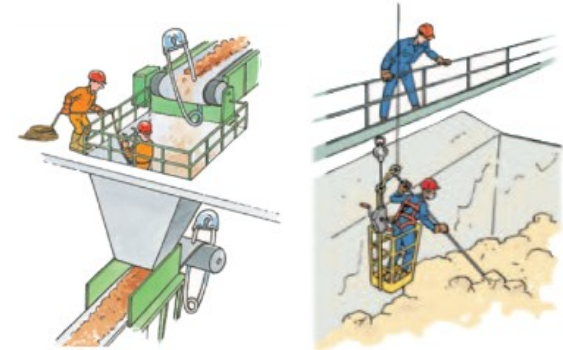

- ▼ Have the operation continuously monitored by a designated person equipped with an alarm system until the work is completed. This person is not allowed to enter the confined room.
- ▼ Check the atmosphere to avoid the risk of suffocation and / or explosion.

Chemical risks



- ▼ Depending on the type of work and the area of application, you may come across these products:



- ▼ The wearing of adapted PPE is mandatory.
- ▼ You may be exposed to dust.
FFP3 type respiratory protection must be worn.
- ▼ Safety data sheets (FDS) are available for inspection. Ask you Vigier contact.



Radioactive radiation

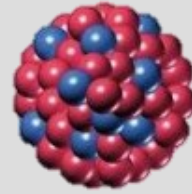

- ▼ There are risks when passing radioactive radiation.
- ▼ The affected areas are marked with this pictogram:



- ▼ If I have to work in an affected area, I check with the Vigier Case Manager if the preventive measures have been implemented (recording of sources, ...).
- ▼ For the online analyser, I can only access the monitored sector if the indicator light is green.



Hot work operations



▼ **Definition:** *All work that generates sparks and / or hot surfaces.*

Examples: Grinding, welding, flame cutting, ...

▼ **Fire permit is MANDATORY**

▼ Ask the Vigier Case Manager.

▼ The permit will be prepared with the external company, the Vigier Case Manager and a person authorised to sign.



A fire permit is only valid for ONE establishment, in ONE zone and for ONE external establishment.

Validity: 1 day

ATEX risks

▼ ATEX: ATmosphère Explosive – Potentially explosive atmospheres

▼ The ATEX zones are marked with these pictograms:



▼ In these zones applies:



▼ For all work in these zones, the measures to be taken must be described in the work permit (cleaning, ventilation, suitable equipment, etc.).



ATEX Zones

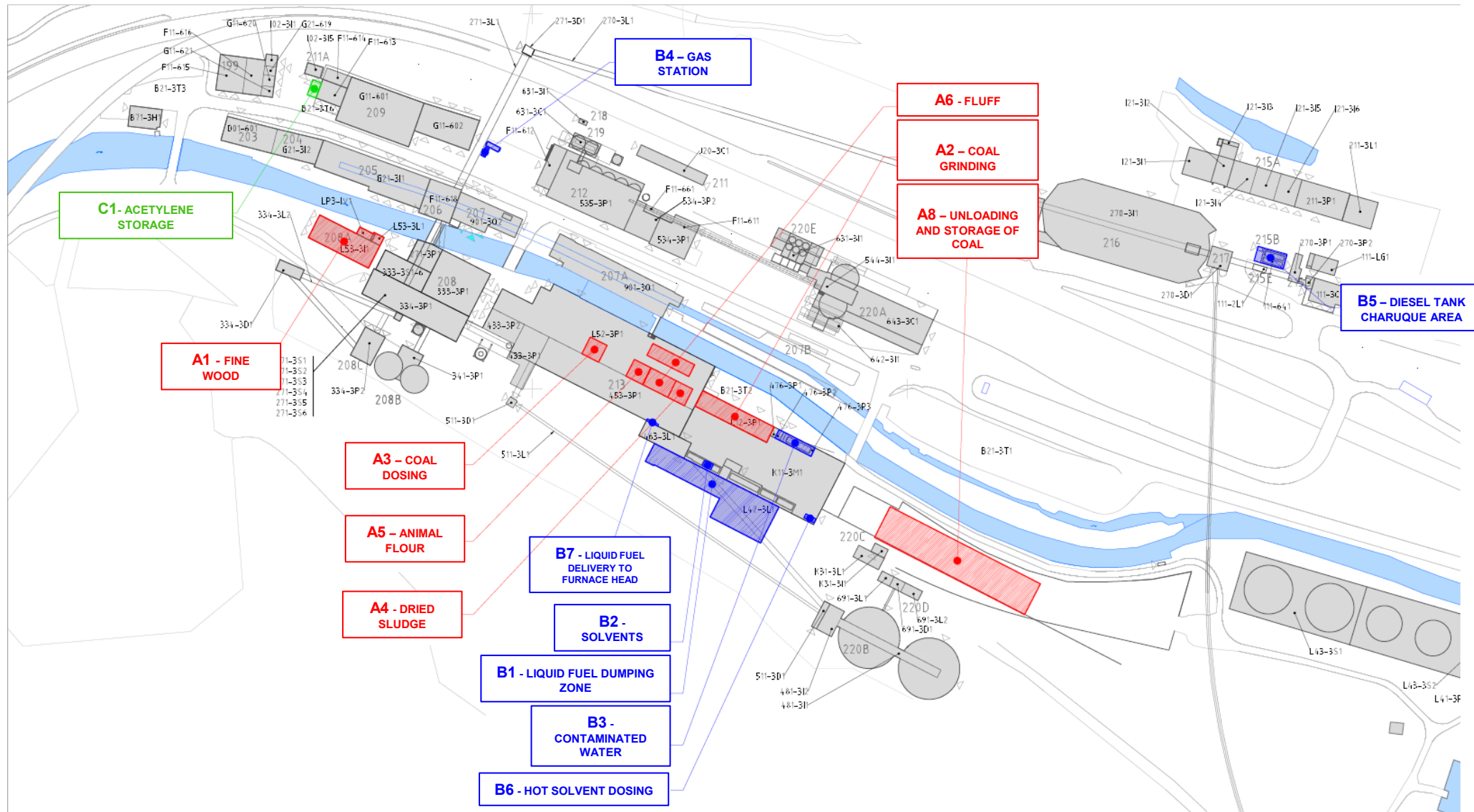

Co-Activities

- ▼ Notice and take note of work around you.
- ▼ Lifts / freight elevators
 - ▼ Observe the maximum load of the equipment.
 - ▼ Do not block equipment.
 - ▼ Lifts / freight elevators always need to be at ground level.
- ▼ Be careful with your equipment (theft, damage...).



Tidiness and cleanliness



- ▼ Do not block passageways.
- ▼ Clean up your work area after each working day, reintroduce collective protective measures or barrier the area.
- ▼ Work is only finished when the site is tidy, clean and **all collective protective equipment (protective housing, railings...)** have been restored to its original state.



Waste / Environment / Energy



- ▼ Waste bins are at your disposal.
 - ▼ Follow the sorting.
- ▼ In case of accidental spillage:
 - ▼ Apply the instruction in case of emergency







What to do in case of an accident?



Each Vigier employee has this number in their phone. You can also save it. In case of emergency, please contact a Vigier employee.

 **Emergency no.**  **+41 (0)32 485 03 24**
 **Landline 112**

 In case of fire	 In case of a leak	 In case of an accident	 Other important call no.																						
<h2>Stay Calm !</h2>																									
<ol style="list-style-type: none"> 1. Call the Emergency No. 2. Rescue 3. Fight the fire if controllable <ul style="list-style-type: none"> • Proceed to the assembly point using the nearest exits. 	<ol style="list-style-type: none"> 1. Call the Emergency No. 2. Secure the accident zone, evacuate if necessary <p style="text-align: center;">Do not act alone!</p>	<ol style="list-style-type: none"> 1. Protect yourself 2. Securing the accident scene 3. Call the Emergency No. 4. If you are a paramedic, give first aid. 	<table style="width: 100%; border: none;"> <tr> <td>Police:</td> <td style="text-align: right;">0 117</td> </tr> <tr> <td>Ambulance:</td> <td style="text-align: right;">0 144</td> </tr> <tr> <td>Helicopter Rescue:</td> <td style="text-align: right;">0 1414</td> </tr> <tr> <td>Poisoning:</td> <td style="text-align: right;">0 145</td> </tr> <tr> <td>Safety Officer:</td> <td></td> </tr> <tr> <td>Benoit Fuetterer</td> <td style="text-align: right;">079 265 57 86</td> </tr> <tr> <td>Environmental Officer :</td> <td></td> </tr> <tr> <td>Mathieu Antoni</td> <td style="text-align: right;">076 233 78 77</td> </tr> <tr> <td>Hazardous Material Officers:</td> <td></td> </tr> <tr> <td>Béat Oppliger</td> <td style="text-align: right;">079 284 52 05</td> </tr> <tr> <td>Timothé Tuffet</td> <td style="text-align: right;">079 159 50 61</td> </tr> </table>	Police:	0 117	Ambulance:	0 144	Helicopter Rescue:	0 1414	Poisoning:	0 145	Safety Officer:		Benoit Fuetterer	079 265 57 86	Environmental Officer :		Mathieu Antoni	076 233 78 77	Hazardous Material Officers:		Béat Oppliger	079 284 52 05	Timothé Tuffet	079 159 50 61
Police:	0 117																								
Ambulance:	0 144																								
Helicopter Rescue:	0 1414																								
Poisoning:	0 145																								
Safety Officer:																									
Benoit Fuetterer	079 265 57 86																								
Environmental Officer :																									
Mathieu Antoni	076 233 78 77																								
Hazardous Material Officers:																									
Béat Oppliger	079 284 52 05																								
Timothé Tuffet	079 159 50 61																								

Hygiene and Health - Main measures and recommendations

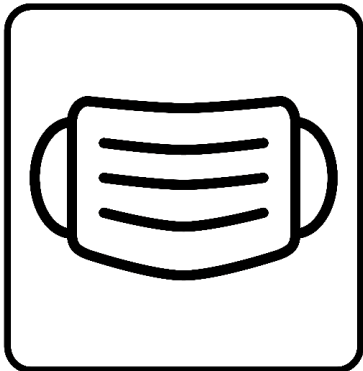
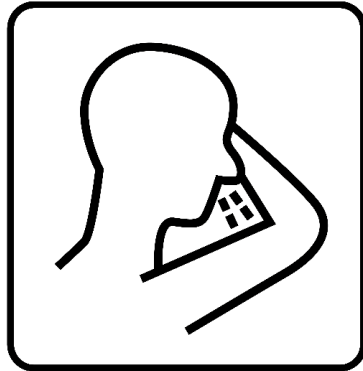

Wear a mask
in case of
symptoms



Keep
changing
rooms and
toilets clean
and tidy



Good behaviour in meeting rooms



400 - 600 ppm

EXCELLENT



601 - 1000 ppm

GOOD / SATISFACTORY



1001 - 1500 ppm

MEDIUM
Polluted ambient air
Ventilation recommended



1501 - 2000 ppm

BAD
Highly polluted ambient air
Ventilation required



> 2000 ppm



Example on 10.12.2021 in the Old Offices room during forklift operator training (6 people present in the room)

Evacuation plan

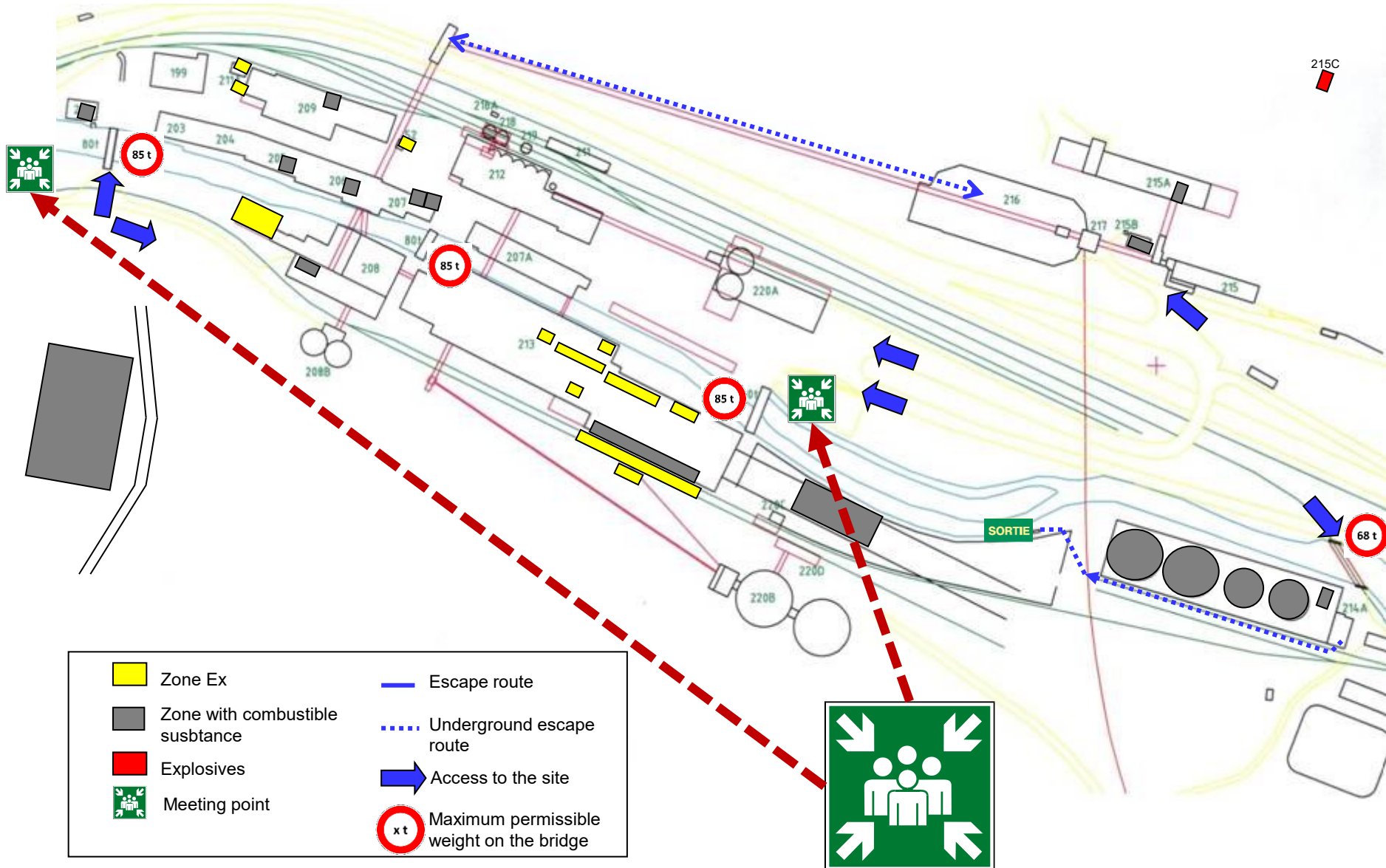

Thanks for your attention

